

**CERTIFIED LAND CORNER RECORDATION**

**LOCATION**

DESCRIPTION OF CORNER EVIDENCE FOUND, AND ORIGINAL RECORD (If known)

R 513 518 R  
67 524 519 66  
W W W

Location is in area worn away by an existing road. No evidence of original corner found.

DESCRIPTION OF MONUMENT AND ACCESSORIES ESTABLISHED TO PERPETUATE THE ORIGINAL LOCATION OF THIS CORNER:

Set  $\frac{3}{8}$  rebar and alum cap  
Corner determined by intersection of south lines of Sections 13 & 18 and east line of Section 13 between found corners

SKETCH, WITH COURSE AND DISTANCE TO ADJACENT CORNER IF DETERMINED IN THIS SURVEY.  
(May Sketch or Paste Reproduction on Reverse Side.)

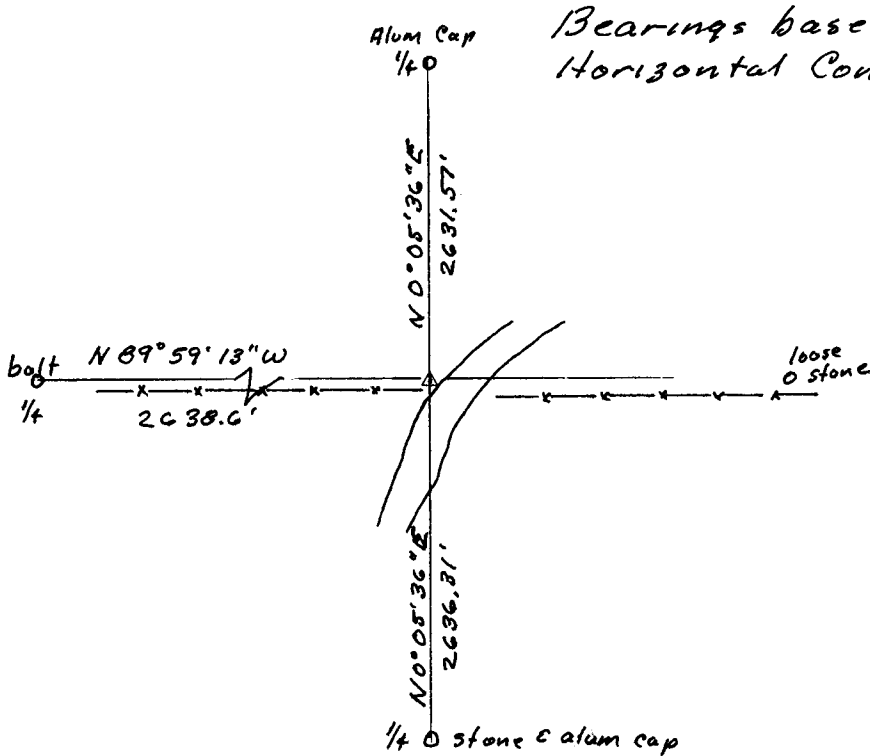

Bearings based on City of Cheyenne Horizontal Control Datum.

I, Francis J. Thornton certify that I have carefully performed or reviewed the work done on the diagrammed corner as reported on this recordation form and approve the same.

Francis J. Thornton Wyo 333 PE & LS.  
Signature of Surveyor Registration No.

STATE OF WYOMING,  
Office of Clerk and Recorder,  
County of Taramie

# 774539

This "corner record" was filed for record on the JAN 8 1985 day of 19, was noted on the cross-index plat and is assigned page No. N-1, in book No.         .

James C. Whitehead  
County Official

|                             |              |              |      |
|-----------------------------|--------------|--------------|------|
| Cross Index No. <u>N-25</u> | T. <u>13</u> | R. <u>67</u> | Mer. |
| <u>N-1</u>                  | T. <u>13</u> | R. <u>66</u> | Mer. |
| _____                       | T. _____     | R. _____     | Mer. |
| _____                       | T. _____     | R. _____     | Mer. |
| _____                       | T. _____     | R. _____     | Mer. |
| _____                       | T. _____     | R. _____     | Mer. |
| _____                       | T. _____     | R. _____     | Mer. |